





INSTITUTIONAL AND PUBLIC SPACES

Galleries, museums, airports, theatres, training centres, libraries,
educational and healthcare institutes

REGIONAL AWARDEES

WINNERS

- **ZONE 2**
THIRD SPACE ARCHITECTURE STUDIO, PUNE

RUNNER UP

- **ZONE 2**
SURAT ANJALI ASSOCIATES, KOLHAPUR

COMMENDATION

- **ZONE 2**
SOMAYA AND KALAPPA, MUMBAI
- **ZONE 3**
ARCHITECTURE AND BEYOND, SURAT
INI DESIGN STUDIO, AHMEDABAD

NATIONAL AWARDEES

- **WINNERS**
THIRD SPACE ARCHITECTURE STUDIO,
PUNE

- **RUNNER UP**
SURAT ANJALI ASSOCIATES, KOLHAPUR

- **COMMENDATION**
SOMAYA AND KALAPPA, MUMBAI

CATEGORY 8

INSTITUTIONAL AND PUBLIC SPACES



The design of the 1,15,000 sq ft indoor sports complex at Shiv Nadar University, Greater Noida was led by the vision of creating a versatile sporting facility comparable to international standards. The essence of the design lies in the balance it achieves between structure and interior space brought by vivacious use of colours and bold graphics juxtaposed with the pronounced muscular form of the building.

The exposed RCC and arterial elements in the structure draw analogy with an active body frame. A curvilinear canopy supported by steel columns and lightweight transparent glazing add flare to the expansive structure. The glass façade provides a visual connect between the inside and the outside. A multi-functional sports hall forms the core of the building. The bold use of graphics and motivational phrases in the interior spaces enhance the inspirational spirit of the building. A screen made in steel with a sports-theme, in the front façade stands out, giving the building an ultra-modern look. The design specifications strictly follow international standards to create a world-class sporting experience to its users. The stadium accommodates a range of contemporary sports. An engaging cafeteria and other open spaces facilitate socializing, making this building 'one-for-all'.



JURY COMMENT

Nominal intervention, effective delineation of space and communicative. Variations in graphic methods and materials work well, effectively creating zones of identity for various activities.

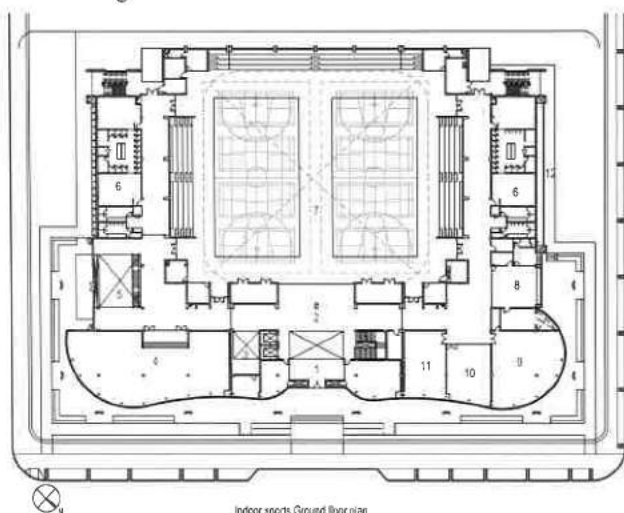

- LEGEND**
 GROUND FLOOR PLAN
 1. ENTRY
 2. RECEPTION
 3. INDOOR CLIMBING WALL
 4. TT+ BOARD GAMES ROOM
 5. CAFÉ
 6. CHANGE ROOMS, LOCKERS, TOILETS
 7. MULTI-PURPOSE SPORTS HALL
 8. ADMINISTRATION
 9. YOGA
 10. POOL ROOM
 11. SEMINAR HALL
 12. OUTDOOR CLIMBING WALL

Indoor sports Ground floor plan